

STEEL STORAGE SERIES CATALOGUE

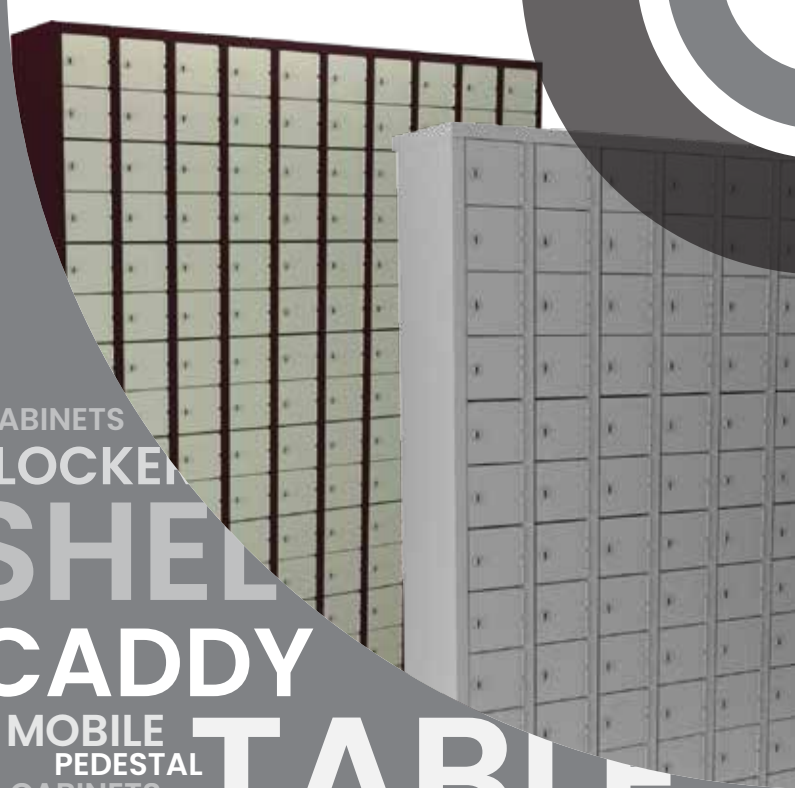

CABINETS
LOCKER
SHELVING
CADDY
MOBILE
PEDESTAL
CABINETS
LOCKER
TABLE
CABINET
SHELVING
WARDROBES
CUPBOARD
WARDROBES
MOBILE
PEDESTAL
LOCKER
SHELVING
PASSPORT
LOCKER
TABLE
MOBILE
PEDESTAL
CABINETS
CADDY
PASSPORT
LOCKER
SHELVING
TABLE

(ADDITIONAL RM 50.00)

*ADD ON SHELF FOR S118 | S118W | S116 | S119 | S118-GS
ADDITIONAL RM 95 PER SHELF

Colour Option:  LIGHT GREY  TWO TONE BEIGE + BROWN  BEIGE



OF-S118
Steel Swinging Door c/w
3 Adjustable Shelves
W915*D457*H1828 (mm)
RM 458



OF-S118LB
Steel Swinging Door & Locking Bar
c/w 3 Adjustable Shelves
W915*D457*H1828 (mm)
RM 598



OF-S118W
Cupboard Without Door c/w
3 Adjustable Shelves
W915*D457*H1828 (mm)
RM 428



OF-S116
Steel Sliding Door c/w
3 Adjustable Shelves
W915*D457*H1828 (mm)
RM 555



OF-S119
Glass Sliding Door c/w
3 Adjustable Shelves
W915*D457*H1828 (mm)
RM 585



OF-S118-GS
Glass Swinging Door c/w
3 Adjustable Shelves
W915*D457*H1828 (mm)
RM 585

HALF HEIGHT CUPBOARD | SHOE RACK

*ADD ON SHELF FOR S110 | S111 | S112 | ST112-SV
ADDITIONAL RM 95 PER SHELF



OF-S112W
Cupboard Without Door
c/w 1 Adjustable Shelf
W915*D457*H915 (mm)
RM 365



OF-S112
Steel Swinging Door c/w
1 Adjustable Shelf
W915*D457*H915 (mm)
RM 375



OF-S111
Steel Sliding Door c/w
1 Adjustable Shelf
W915*D457*H915 (mm)
RM 385



OF-S110
Glass Sliding Door c/w
1 Adjustable Shelf
W915*D457*H915 (mm)
RM 399



OF-S168
Steel Shoe Rack with Steel Swing Door
& Cupboard Lock c/w 4 Fixed Shelves
W1000*D400*H800 (mm)
RM 628

Specification for OF-S168:



Cupboard Lock



Ventilation Holes



Fixed Shelves



OF-ST112
Steel Swinging Door c/w
2 Adjustable Shelves
W915*D457*H1016 (mm)
RM 399

Colour Option:  LIGHT GREY  TWO TONE BEIGE + BROWN  BEIGE

(ADDITIONAL RM 50.00)

WARDROBE

Colour Option: LIGHT GREY TWO TONE BEIGE + BROWN BEIGE (ADDITIONAL RM 50.00)



OF-S198

Full Height Steel Swinging Door c/w 1 Clothes Hanging Bar, 3 Fixed Shelves, 1 Drawer with Camlock & 1 Mirror
W915*D525*H1828 (mm)

RM 738



OF-S199

Full Height Steel Swinging Door c/w 1 Adjustable Top Shelf & 1 Bottom Clothes Hanging Bar
W915*D457*H1828 (mm)

RM 538



OF-S200

Full Height Wardrobe with Steel Swinging Door c/w 1 Top Clothes Hanging Bar & 1 Bottom Adjustable Shelf
W915*D457*H1828 (mm)

RM 538

FILING CABINET

Colour Option: LIGHT GREY TWO TONE BEIGE + BROWN BEIGE (ADDITIONAL RM 50.00)

Specification:

Recess Handle Ball Bearing Slide



OF-S106 / AB

4 Drawers Filing Cabinet with Recess Handle c/w Ball Bearing Slide
W465*D625*H1320 (mm)

RM 399



OF-S106 / ABL

4 Drawers Filing Cabinet with Recess Handle c/w Ball Bearing Slide & Locking Bar
W465*D625*H1320 (mm)

RM 539



OF-S106 / BB | OF-S106 / BBLB

3 Drawers Filing Cabinet with Recess Handle c/w Ball Bearing Slide
W465*D625*H1020 (mm)

RM 395 RM 535



OF-S106 / CB | OF-S106 / CBLB

2 Drawers Filing Cabinet with Recess Handle c/w Ball Bearing Slide
W465*D625*H720 (mm)

RM 390 RM 530



OF-S106 / 5A

5 Drawers Filing Cabinet with Recess Handle c/w Ball Bearing Slide
W465*D625*H1620 (mm)

RM 588

OF-S106 / 5ALB

RM 728



(ADDITIONAL RM 50.00)

Colour Option:



LIGHT GREY



BEIGE



Central Locking



Lateral Shelf



Handle

OF-S117 / A RM 2,688

4 x 1 Bay Depth Hand Push Mobile Compactor
Size : W2440*D915*H2115 (mm)

* 1 BAY DEPTH
ODD NUMBER BAY
ADDITIONAL RM110 NETT

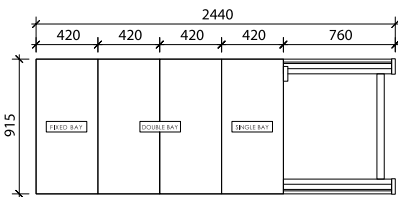

OF-S117 / AD RM 5,388

4 x 2 Bays Depth Hand Push Mobile Compactor
Size : W2440*D1830*H2115 (mm)

* 2 BAY DEPTH
ODD NUMBER BAY
ADDITIONAL RM220 NETT

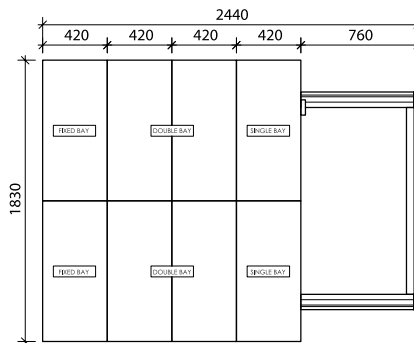

HAND PUSH MOBILE COMPACTOR WITH CENTRAL LOCKING

Our mobile compactor filing system is designed as a practical, efficient, and cost-effective storage solutions. The shelving systems will not only help you save space, it will also maximize your existing storage. It also provides user with easy retrieval of documents and data when needed as all storage is centralized. Our mobile compactor filing system is also designed for heavy duty usage and handling with high durability.

Per Bay Measurement : W915*D420*H2115 (mm)
(Standard)

No.of shelf per bay : With built-in lateral file holder, 4 pieces of lateral shelf and 1 piece base shelf to provide 5 tier filing storage. (Max loading capacity: 50 kgs per shelf)

Material used : - Cold Rolled Steel plate for the whole Bay's body and shelves. (0.7mm)
- Square Hollow Section and Steel Flat Bar for the track / rail.
- Cold Rolled Steel Bearing and Bearing Base.

: Powder Coating

Locking Device Finish : A central locking provided on the back of last single mobile bay for simple locking purposes.

MANUAL MOBILE STORAGE SYSTEM



SPECIFICATIONS

Standard Height	: 2082mm
Standard Width	: 914mm
Standard Depth	: 772mm for double bay
Standard Depth	: 386mm for single bay
Standard Shelf	: W910*D345*H25mm
Aisle Space	: 762mm (minimum)
Loading Capacity (per shelf)	: 50kgs
Loading Capacity (per bay)	: 250kgs
Weight (per bay) Unloaded	: 50kgs

FEATURES & OPTIONS

- Central locking
- Sound buffer pad
- User friendly handle
- Powder epoxy coating
- Shelf adjustable every 25mm height
- Easy retrieval & reference

RM 999
per bay

*Due to heavy fluctuation in steel raw material price, steel product pricing is subject to change without prior notice.



Special Decorative Front Panel



CD Rack



Dual Purpose Shelf



Front or Back Stopper



Pull-out Lateral Frame



Pull-out Reference Shelf



Sliding Divider



Overhanging Divider



Lateral Filing Frame

MECHANICAL MOBILE STORAGE SYSTEM

SPECIFICATIONS

Standard Height	: 2215mm (inclusive of track)
Standard Width	: 915mm (starting bay)
	: 915mm (add-on-bay)
Standard Depth	: 812mm for Double Bay
Standard Depth	: 406mm for Single Bay
Standard Dual Purpose Shelf	: W909*D362*H26mm
Aisle Space	: 800mm
Loading Capacity (per shelf)	: 65kgs
Loading Capacity (per bay)	: 325kgs
Weight (per bay) Unloaded	: 70kgs

FEATURES & OPTIONS

- Anti-tilt
- Central locking
- Safety lock
- Sound buffer pad
- Steering wheel
- Powder epoxy coating
- Shelf adjustable every 43mm height
- Solid bar 32mmx 16mm tracks

SAVE 50% SPACE
RM 1,308
per bay

* (Min order 8 bays)



(ADDITIONAL RM 50.00)

Body Colour Option:



LIGHT GREY



TWO TONE BEIGE + BROWN



BEIGE

Melamine Chipboard Colour Option



LIGHT GREY



BEECH



CHERRY



MAPLE



OF-S102 / MT

4' Single Pedestal Desk
(Melamine Chipboard Top)
W1220*D762*H762 (mm)

RM 829



OF-S101 / LT RM 1,468

5' L-Shape Pedestal Desk
(Black Linoleum Top)
W1524*D762*H762 (mm)

OF-S101 / MT RM 1,628

5' L-Shape Pedestal Desk
(Melamine Chipboard Top)
W1524*D762*H762 (mm)



OF-S103 / MT

5' Double Pedestal Desk
(Melamine Chipboard Top)
W1524*D762*H762 (mm)

RM 978



* Only available in
Beige / Brown

OF-ST-102-H

4' Single Pedestal Desk with Block Leg
(Black Linoleum Top)
W1220*D762*H762 (mm)

RM 598



* Only available in
Beige / Brown

OF-ST-103A-H

5' Double Pedestal Desk
(Black Linoleum Top)
W1524*D762*H762 (mm)

RM 718



* Only available in
Black Linoleum Top

OF-S136

4' General Purpose Table
with Centre Drawer
W1220*D762*H762 (mm)

RM 788



* Only available in
Black Linoleum Top

OF-S104 / A

4' Utility Table
W1220*D762*H762 (mm)

RM 788

OF-S104 / B

5' Utility Table
W1524*D762*H762 (mm)

RM 888

OF-S137

5' General Purpose Table
with Centre Drawer
W1524*D762*H762 (mm)

RM 828

MULTIPLE LOCKER

Colour Option: LIGHT GREY TWO TONE BEIGE + BROWN BEIGE (ADDITIONAL RM 50.00)

Locker Lock Option:

CALL FOR BEST PRICE



OF-SLK-S114-HLL
Handle Latch Lock



OF-SLK-S114-HL
Handle Cam Lock
ADDITIONAL:
RM2 PER DOOR



OF-SLK-S114-DL
Digital Combination Lock
ADDITIONAL:
RM35 PER DOOR



Ear Hinges
ADDITIONAL:
RM40 PER DOOR

3 Compartment Steel Locker * With Clothes Hanging Bar



- 4 Optional Size :**
OF-S140 / A
 15"D - W915*D381*H1828 (mm) **RM 748**
OF-S140 / AS
 18"D - W915*D457*H1828 (mm) **RM 778**
OF-S138 / A
 15"D - W1143*D381*H1828 (mm) **RM 818**
OF-S138 / AS
 18"D - W1143*D457*H1828 (mm) **RM 838**

6 Compartment Steel Locker * With Clothes Hanging Bar



- 4 Optional Size :**
OF-S141 / A
 15"D - W915*D381*H1828 (mm) **RM 788**
OF-S141 / AS
 18"D - W915*D457*H1828 (mm) **RM 818**
OF-S139 / A
 15"D - W1143*D381*H1828 (mm) **RM 848**
OF-S139 / AS
 18"D - W1143*D457*H1828 (mm) **RM 888**

9 Compartment Steel Locker



- 4 Optional Size :**
OF-S105 / A
 15"D - W915*D381*H1828 (mm) **RM 798**
OF-S105 / AS
 18"D - W915*D457*H1828 (mm) **RM 828**
OF-S135 / A
 15"D - W1143*D381*H1828 (mm) **RM 858**
OF-S135 / AS
 18"D - W1143*D457*H1828 (mm) **RM 898**

12 Compartment Steel Locker



- 4 Optional Size :**
OF-S107 / A
 15"D - W915*D381*H1828 (mm) **RM 808**
OF-S107 / AS
 18"D - W915*D457*H1828 (mm) **RM 858**
OF-S108 / A
 15"D - W1143*D381*H1828 (mm) **RM 898**
OF-S108 / AS
 18"D - W1143*D457*H1828 (mm) **RM 938**

15 Compartment Steel Locker



- 4 Optional Size :**
OF-S125 / A
 15"D - W915*D381*H1828 (mm) **RM 818**
OF-S125 / AS
 18"D - W915*D457*H1828 (mm) **RM 868**
OF-S126 / A
 15"D - W1143*D381*H1828 (mm) **RM 918**
OF-S126 / AS
 18"D - W1143*D457*H1828 (mm) **RM 958**

18 Compartment Steel Locker



- 4 Optional Size :**
OF-S109 / A **PROMOTION**
 15"D - W915*D381*H1828 (mm) **RM 799**
OF-S109 / AS
 18"D - W915*D457*H1828 (mm) **RM 908**
OF-S115 / A **PROMOTION**
 15"D - W1143*D381*H1828 (mm) **RM 838**
OF-S115 / AS
 18"D - W1143*D457*H1828 (mm) **RM 988**

• Images provided are for illustration purposes only. • Prices quoted are subject to change without prior notice & while stocks last.
 • Terms & conditions apply. • While every care is taken in the preparation of this flyer any inaccuracy or omission is much regretted.

(ADDITIONAL RM 50.00)

Colour Option:  LIGHT GREY

 TWO TONE BEIGE + BROWN

 BEIGE

Locker Lock Option:

CALL FOR BEST PRICE



OF-SLK-S114-HLL
Handle
Latch Lock



OF-SLK-S114-HL
Handle
Cam Lock

ADDITIONAL:
RM2 PER DOOR



OF-SLK-S114-DL
Digital
Combination
Lock

ADDITIONAL:
RM35 PER DOOR



Ear Hinges

ADDITIONAL:
RM40 PER DOOR

1 Compartment Steel Locker
* With Clothes Hanging Bar



2 Optional Size :
OF-S114 / D
15"D - W381*D381*H1828 (mm) **RM 265**
OF-S114 / DS
18"D - W381*D457*H1828 (mm) **RM 305**

2 Compartment Steel Locker
* With Clothes Hanging Bar



2 Optional Size :
OF-S114 / C
15"D - W381*D381*H1828 (mm) **RM 275**
OF-S114 / CS
18"D - W381*D457*H1828 (mm) **RM 315**

3 Compartment Steel Locker



2 Optional Size :
OF-S114 / 3
15"D - W381*D381*H1828 (mm) **RM 280**
OF-S114 / 3S
18"D - W381*D457*H1828 (mm) **RM 320**

4 Compartment Steel Locker



2 Optional Size :
OF-S114 / B
15"D - W381*D381*H1828 (mm) **RM 285**
OF-S114 / BS
18"D - W381*D457*H1828 (mm) **RM 325**

5 Compartment Steel Locker



2 Optional Size :
OF-S114 / E
15"D - W381*D381*H1828 (mm) **RM 295**
OF-S114 / ES
18"D - W381*D457*H1828 (mm) **RM 340**

6 Compartment Steel Locker



2 Optional Size :
OF-S114 / A
15"D - W381*D381*H1828 (mm) **RM 298**
OF-S114 / AS
18"D - W381*D457*H1828 (mm) **RM 345**

PIGEON HOLES

Colour Option:  LIGHT GREY  TWO TONE BEIGE + BROWN  BEIGE (ADDITIONAL RM 50.00)



6 Pigeon Holes
OF-S113/A **RM 308**
W915*D381*H930 (mm)



9 Pigeon Holes
OF-S113/B **RM 328**
W915*D381*H890 (mm)



12 Pigeon Holes
4 Optional Size :
OF-SPH12/3615 15"D - W915*D381*H1828 (mm) **RM 628**
OF-SPH12/3618 18"D - W915*D457*H1828 (mm) **RM 648**
OF-SPH12/4515 15"D - W1143*D381*H1828 (mm) **RM 668**
OF-SPH12/4518 18"D - W1143*D457*H1828 (mm) **RM 688**



15 Pigeon Holes
4 Optional Size :
OF-SPH15/3615 15"D - W915*D381*H1828 (mm) **RM 698**
OF-SPH15/3618 18"D - W915*D457*H1828 (mm) **RM 708**
OF-SPH15/4515 15"D - W1143*D381*H1828 (mm) **RM 718**
OF-SPH15/4518 18"D - W1143*D457*H1828 (mm) **RM 728**



18 Pigeon Holes
4 Optional Size :
OF-SPH18/3615 15"D - W915*D381*H1828 (mm) **RM 758**
OF-SPH18/3618 18"D - W915*D457*H1828 (mm) **RM 768**
OF-SPH18/4515 15"D - W1143*D381*H1828 (mm) **RM 778**
OF-SPH18/4518 18"D - W1143*D457*H1828 (mm) **RM 788**

HALF HEIGHT MULTIPLE LOCKER

6 Compartment Steel Locker



4 Optional Size :
OF-S127 / A 15"D - W915*D381*H915 (mm) **RM 608**
OF-S127 / AS 18"D - W915*D457*H915 (mm) **RM 638**
OF-S128 / A 15"D - W1143*D381*H915 (mm) **RM 668**
OF-S128 / AS 18"D - W1143*D457*H915 (mm) **RM 688**

9 Compartment Steel Locker



4 Optional Size :
OF-S129 / A 15"D - W915*D381*H915 (mm) **RM 648**
OF-S129 / AS 18"D - W915*D457*H915 (mm) **RM 688**
OF-S130 / A 15"D - W1143*D381*H915 (mm) **RM 708**
OF-S130 / AS 18"D - W1143*D457*H915 (mm) **RM 728**

MOBILE PEDESTAL



OF-S180
Steel Mobile Pedestal with Ball Bearing Slide 2 Drawer + 1 File
W400*D490*H680 (mm)
RM 408



OF-S181
Steel Mobile Pedestal with Ball Bearing Slide 3 Drawer
W400*D490*H550 (mm)
RM 405



OF-S182
Steel Mobile Pedestal with Ball Bearing Slide 1 Drawer + 1 File
W400*D490*H530 (mm)
RM 398

Specification:



Ball Bearing Slide

• Images provided are for illustration purposes only. • Prices quoted are subject to change without prior notice & while stocks last.
• Terms & conditions apply. • While every care is taken in the preparation of this flyer any inaccuracy or omission is much regretted.

5 Level - Single Sided



OF-S315 - with Side Panel RM 608
W950*D313*H1690 (mm)
OF-S315W - without Side Panel RM 578
W950*D313*H1690 (mm)

6 Level - Single Sided



OF-S316 - with Side Panel RM 698
W950*D313*H1995 (mm)
OF-S316W - without Side Panel RM 648
W950*D313*H1995 (mm)

7 Level - Single Sided



OF-S317 - with Side Panel RM 798
W950*D313*H2300 (mm)
OF-S317W - without Side Panel RM 718
W950*D313*H2300 (mm)

5 Level - Double Sided



OF-S325 - with Side Panel RM 788
W950*D550*H1690 (mm)
OF-S325W - without Side Panel RM 668
W950*D550*H1690 (mm)

6 Level - Double Sided



OF-S326 - with Side Panel RM 848
W950*D550*H1995 (mm)
OF-S326W - without Side Panel RM 778
W950*D550*H1995 (mm)

7 Level - Double Sided



OF-S327 - with Side Panel RM 978
W950*D550*H2300 (mm)
OF-S327W - without Side Panel RM 878
W950*D550*H2300 (mm)

ACCESSORIES



OF-SLK-S118
Cupboard Lock



OF-SLK-S114
Locker Lock



OF-SLK-S119
Sliding Door Lock



OF-SLK-S106
Drawer Lock



OF-SSV-S117
Shelf OF-S117 c/w 4 clips



OF-SSV-S119
Shelf OF-S110 / OF-S111 /
OF-S116 / OF-S119 c/w 4 clips

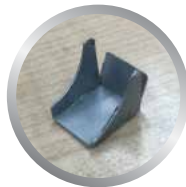

OF-S135
Shelf Clip
(MOQ - 4 pcs)

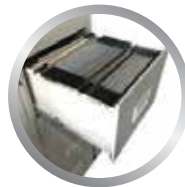

Filing Pocket - Link
(1 Box - 2 sets)



OF-S129-1
Lateral Filing Pocket - Single
(1 Box - 50 pcs)



OF-SSV-S118
Shelf OF-S112 / OF-S118 /
OF-S199 / OF-S200 c/w 4 clips

PASSPORT / HANDPHONE LOCKER

Colour Option: LIGHT GREY TWO TONE BEIGE + BROWN



9 COMPARTMENTS
W425*D180*H446 (mm)



42 COMPARTMENTS
W826*D250*H894 (mm)



72 COMPARTMENTS
W826*D250*H1454 (mm)



90 COMPARTMENTS
W834*D250*H1790 (mm)



120 COMPARTMENTS
W1104*D250*H1790 (mm)



150 COMPARTMENTS
W1380*D250*H1790 (mm)

Locker Lock Option:

CamLock

PadLock



PROJECTS WELCOMED

CUSTOMMADE ITEM



OF-SCM-0001
W750*D470*H2100 (mm)

Full Height Wardrobe with Steel Swinging Door c/w 1 Mirror & Cupboard Lock, 1 Top Shelf, 1 Divider, 4 Small Fixed Shelf & 1 Clothes Hanging Bar

RM 1,038



OF-SCM-0002
W457*D508*H1828 (mm)

1 Compartment Steel Locker with Swinging Door c/w 1 Hanging Bar, 1 Mirror, 1 Centre Drawer, 1 Bottom Fixed Shelf

RM 548

Colour Option:

- LIGHT GREY
- TWO TONE BEIGE + BROWN
- (ADDITIONAL RM 50.00)
- BEIGE



OF-SCM-0003
W915*D381*H2100

36 Compartment steel Locker with Swinging Door

RM 2,188



OF-SCM-0004
W915*D457*H1828 (mm)

Full Height 30 Pigeon Hole

RM 1,888



OF-SCM-0005
W381*D381*H1828 (mm)

12 Compartment Steel Locker with Swinging Door

RM 728

VERTICAL | LATERAL FILING CABINETS



VF25
2 Drawers
Vertical Filing Cabinet
W460*D620*H722 (mm)
RM 490

VF35
3 Drawers
Vertical Filing Cabinet
W460*D620*H1020 (mm)
RM 495

VF45
4 Drawers
Vertical Filing Cabinet
W460*D620*H1320 (mm)
RM 499

LF20
2 Drawers
Lateral Filing Cabinet
W900*D500*H755 (mm)
RM 695

LF30
3 Drawers
Lateral Filing Cabinet
W900*D500*H1050 (mm)
RM 785

LF40
4 Drawers
Lateral Filing Cabinet
W900*D500*H1345 (mm)
RM 885

SWINGING / SLIDING / GLASS SLIDING / OPEN SHELF / PIGEON HOLES CUPBOARDS



STEEL SWING DOOR
HC15 (1 Shelf) W915*D457*H1000 (mm) **RM 420**
FC15 (3 Shelves) W915*D457*H1830 (mm) **RM 599**



STEEL SLIDING DOOR
HC20 (1 Shelf) W915*D457*H1000 (mm) **RM 440**
FC20 (3 Shelves) W915*D457*H1830 (mm) **RM 648**



GLASS SLIDING DOOR
HC30 (1 Shelf) W915*D457*H1000 (mm) **RM 480**
FC30 (3 Shelves) W915*D457*H1830 (mm) **RM 698**



OPEN SHELF
HO10 (1 Shelf) W915*D457*H1000 (mm) **RM 350**
FO10 (3 Shelves) W915*D457*H1830 (mm) **RM 468**



TRIPLE COLUMN 18 COMPARTMENTS OPEN TYPE OS18
W915*D457*H1828 (mm)
RM 738

WARDROBES



SINGLE DOOR WARDROBE
WR10 W457*D457*H1828 (mm) **RM 488**

- Features:**
- Clothes hanger
 - Top Shelf
 - D-system lock or Camlock
 - In built drawer



2-DOORS DOMESTIC WARDROBE
WR50 W900*D457*H1850 (mm) **RM 688**

SINGLE COLUMN LOCKERS



Features:

- Clothes hanger (LS01 & LS02)
- D-system lock or Camlock
- Fixed shelves
- Louvered
- Electronic lock (Optional)
- Leg stand (Optional)

MODEL	DESCRIPTION	SIZE	PRICE
LS01	1 Compartment	W381*D457*H1828	RM 340
LS02	2 Compartment	W381*D457*H1828	RM 350
LS03	3 Compartment	W381*D457*H1828	RM 370
LS04	4 Compartment	W381*D457*H1828	RM 390
LS06	6 Compartment	W381*D457*H1828	RM 430

DOUBLE COLUMN LOCKERS



Features:

- Clothes hanger
- D-system lock or Camlock
- Electronic lock (Optional)
- Leg stand (Optional)

MODEL	DESCRIPTION	SIZE	PRICE
LD02	Double Column 2 compartment	W610*D457*H1828	RM 798
LD04	Double Column 4 compartment	W610*D457*H1828	RM 898

TRIPLE COLUMN LOCKER



MODEL	DESCRIPTION	SIZE	PRICE
LT06	Triple Column 6 compartment	W915*D457*H1828	RM 858
LT12	Triple Column 12 compartment	W915*D457*H1828	RM 898
LT18 (18")	Triple Column 18 compartment	W915*D457*H1828	RM 1,068
LT18 (15")	Triple Column 18 compartment	W915*D318*H1828	RM 988

STANDARD DESK

Table Top Colour Option:

- GREY
- BEECH
- CHERRY



SD41 **RM 828**
W1220*D762*H740 (mm)



SD51 **RM 1,068**
W1500*D762*H740 (mm)

Features:

- MDF Table Top
- Center Drawer
- Modesty Panel
- Power Grommet



- 36 Hole Stainless Steel Cabinet
- 304 Stainless Steel Imm THK
- Numbering Security lock
- Numbering Label

RM 3,988

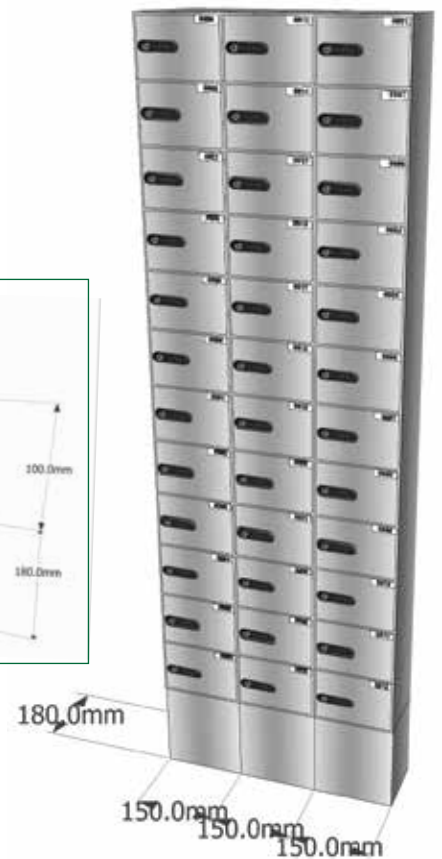
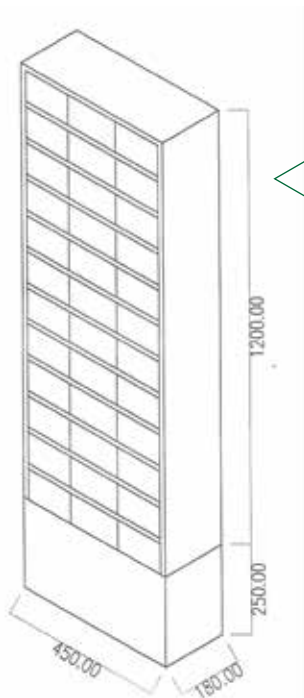



STEEL STORAGE SERIES

